

# MÖVENPICK

HOTEL AMSTERDAM  
CITY CENTRE



*your event*

our expertise





Click for a  
3D Tour  
of our  
rooms

## Unforgettable events await

Celebrate your product launch, gala dinner or brand anniversary, while your guests stay on location in the heart of Amsterdam. Create an extraordinary experience.

Located in the Eastern Docklands, within walking distance from Central Station, we pride ourselves in being the most accessible hotel in the city. Mövenpick Hotel Amsterdam City Centre offers 408 elegant rooms with spectacular views over the city and IJ River. Our meeting spaces are divided into 11 flexible state-of-the-art meeting rooms.

Our Conference and Events team will be happy to help you plan an unforgettable event.

### Sustainable methods of transportation to the hotel:

Mövenpick Hotel Amsterdam City Centre is within walking distance from Amsterdam Central Station.

#### by tram

Tram 26 stops in front of the hotel.

#### by bike

From Amsterdam Central Station, follow the Ruyterkade in the eastern direction and park your bike in the free bike parking underneath the hotel.

#### by Taxi Electric

This taxi service operates 100% electric cars which are equipped with free WiFi access and a tablet.

#### by boat

The hotel is directly located on the IJ River next to the Passenger Terminal Amsterdam. You can also reach us by boat and dock right in front of the hotel.

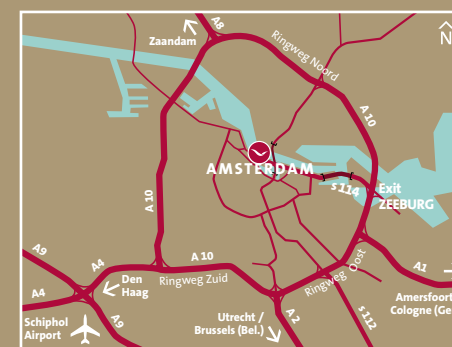

Mövenpick Hotel Amsterdam City Centre  
Piet Heinkade 11 | 1019 BR Amsterdam | Netherlands  
+31 20 519 1200 | hotel.amsterdam@movenpick.com

[movenpick.com](https://movenpick.com)





Meeting Room Matterhorn



Meeting Room Basel



Meeting Room Zurich



Meeting Room Lausanne







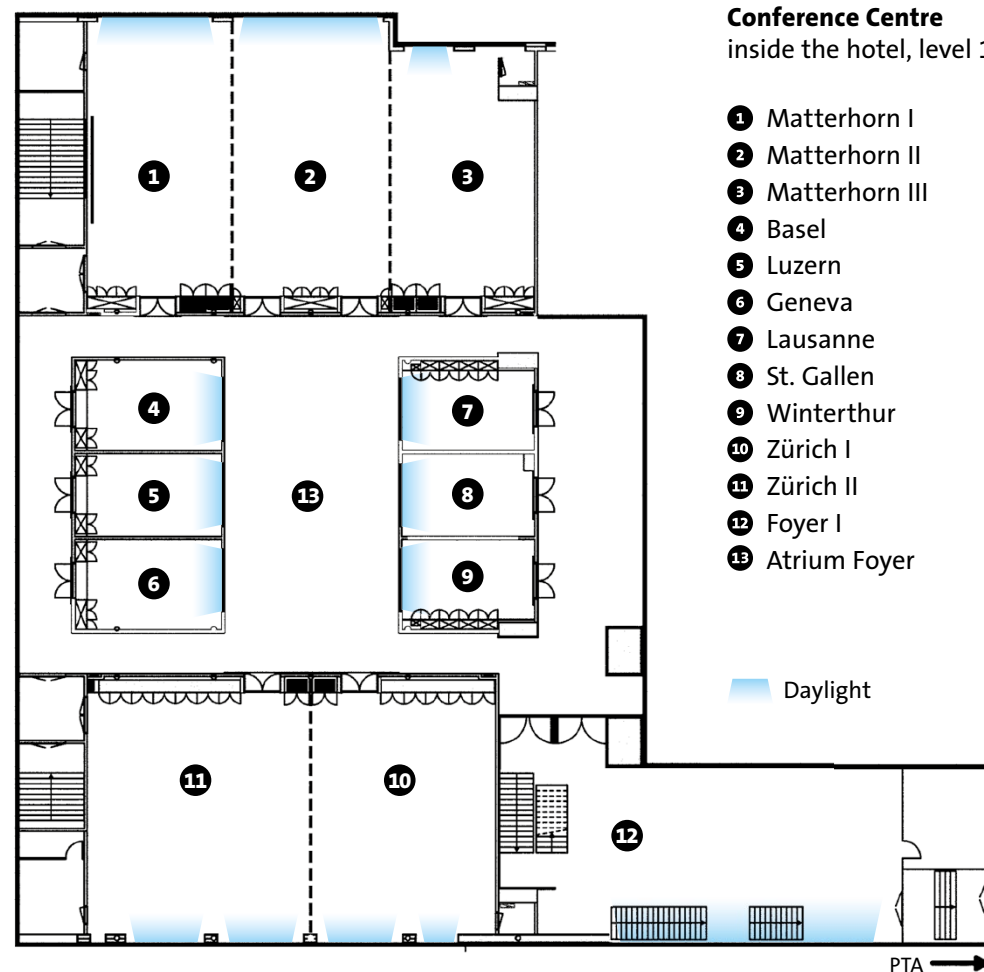

## Conferences

### Create an extraordinary experience

Organise your event at Mövenpick Hotel Amsterdam City Centre. Our conference & meeting centre can accommodate events up to 450 delegates in 11 flexible meeting and breakout rooms (1,100 sqm). All meeting rooms are equipped with the latest technical equipment which can be remotely controlled by a touchscreen, free WiFi and state of the art AV solutions.



## Capacities Conference Centre

| Room                    | Theatre<br> | Classroom<br>2 persons<br>per table<br> | Classroom<br>3 persons<br>per table<br> | U shape<br> | Carré<br> | Boardroom<br> | Banquet<br>rounds<br> | Cabaret half<br>rounds<br>6 persons<br>per table<br> | Cabaret half<br>rounds<br>7 persons<br>per table<br> |
|-------------------------|--|--|--|--|--|--|--|---|---|
| Matterhorn I            | 112  | 56   | 84   | 30   | 36   | —  | 56   | 48  | 56  |
| Matterhorn II           | 150  | 64   | 96   | 36   | 36   | —  | 63   | 54  | 63  |
| Matterhorn III          | 100  | 40   | 60   | 26   | 32   | —  | 42   | 36  | 42  |
| Matterhorn I & II       | 250  | 120  | 180  | 44   | 56   | —  | 84   | 78  | 120   |
| Matterhorn II & III     | 250  | 84   | 126  | 36   | 60   | —  | 140  | 114   | 133   |
| Matterhorn I & II & III | 450  | 160  | 240  | 60   | 80   | —  | 250  | 180   | 210   |
| Zurich I                | 136  | 60   | 90   | 34   | 44   | —  | 63   | 54  | 63  |
| Zurich II               | 150  | 70   | 105  | 36   | 48   | —  | 108  | 96  | 108   |
| Zurich I & II           | 300  | 140  | 210  | 56   | —  | —  | 168  | 144   | 168   |
| Basel                   | —  | —  | —  | —  | —  | 16   | —  | —   | —   |
| Geneva                  | —  | —  | —  | —  | —  | 16   | —  | —   | —   |
| Luzern                  | 30   | 20   | 30   | 14   | —  | 16   | 21   | 18  | 21  |
| St. Gallen              | 30   | 20   | 30   | 14   | —  | 16   | 21   | 18  | 21  |
| Lausanne                | 30   | 20   | 30   | 14   | —  | 16   | 21   | 18  | 21  |
| Winterthur              | 30   | 20   | 30   | 14   | —  | 16   | 21   | 18  | 21  |

Note: These capacities are calculated taking into account the in-house stage.  
Kindly contact your C&E executive for a more detailed overview.

## Dimensions Conference Centre

| Room                    | Length |        | Width |       | Height min – max |               | Area |        |
|-------------------------|--------|--------|-------|-------|------------------|---------------|------|--------|
|                         | m      | ft     | m     | ft    | m                | ft            | m²   | sq. ft |
| Matterhorn I            | 15.56  | 51.05  | 8.22  | 26.97 | 3.10 – 3.60      | 10.17 – 11.80 | 128  | 1377   |
| Matterhorn II           | 15.56  | 51.05  | 8.96  | 29.40 | 3.10 – 3.60      | 10.17 – 11.80 | 139  | 1501   |
| Matterhorn III          | 13.88  | 45.54  | 8.26  | 27.10 | 3.10 – 3.60      | 10.17 – 11.80 | 114  | 1234   |
| Matterhorn I & II       | 17.18  | 56.36  | 15.56 | 51.05 | 3.10 – 3.60      | 10.17 – 11.80 | 267  | 2878   |
| Matterhorn II & III     | 17.22  | 56.50  | 15.56 | 51.05 | 3.10 – 3.60      | 10.17 – 11.80 | 253  | 2735   |
| Matterhorn I & II & III | 25.44  | 283.46 | 15.56 | 51.05 | 3.10 – 3.60      | 10.17 – 11.80 | 381  | 4112   |
|                         |        |        |       |       |                  |               |      |        |
| Zurich I                | 13.70  | 44.95  | 10.54 | 34.08 | 3.40 – 3.60      | 10.17 – 11.80 | 144  | 1554   |
| Zurich II               | 13.70  | 44.95  | 12.69 | 41.63 | 3.40 – 3.60      | 10.17 – 11.80 | 174  | 1871   |
| Zurich I & II           | 23.23  | 76.21  | 13.70 | 44.95 | 3.40 – 3.60      | 10.17 – 11.80 | 318  | 3425   |
|                         |        |        |       |       |                  |               |      |        |
| Basel                   | 7.64   | 25.07  | 5.13  | 16.83 | 3.60             | 11.80         | 39   | 422    |
| Geneva                  | 7.64   | 25.07  | 4.70  | 15.42 | 3.60             | 11.80         | 36   | 387    |
| Luzern                  | 7.53   | 24.70  | 4.60  | 15.09 | 3.60             | 11.80         | 34   | 370    |
| St. Gallen              | 7.58   | 24.78  | 4.53  | 14.86 | 3.60             | 11.80         | 34   | 370    |
| Lausanne                | 7.64   | 25.07  | 5.13  | 16.83 | 3.60             | 11.80         | 39   | 422    |
| Winterthur              | 7.58   | 24.78  | 4.70  | 15.42 | 3.60             | 11.80         | 36   | 383    |
|                         |        |        |       |       |                  |               |      |        |
| Foyer I                 | 19.00  | 62.33  | 6.70  | 21.98 | 3.60             | 11.80         | 127  | 1370   |
| Foyer II                | 15.70  | 51.51  | 5.70  | 18.70 | 3.60             | 11.80         | 89   | 963    |
| Atrium Foyer            | 15.70  | 51.51  | 9.90  | 32.48 | 3.60             | 11.80         | 155  | 1673   |

## Meeting packages

### Classic

- Dedicated meeting room
- The use of 1 beamer and screen in the meeting room
- Complimentary high speed wireless internet
- Morning and afternoon coffee and tea with an assortment of Dutch treats and fresh seasonal fruits
- Lunch with luxurious sandwiches, wraps and rolls, fresh salad bar, soup or hot snack, dessert, coffee, tea and Amsterdam Water

### Superior

- Dedicated meeting room
- The use of 1 flipchart, beamer and screen in the meeting room
- Complimentary high speed wireless internet
- Welcome coffee and tea with cookies
- Morning and afternoon coffee break which includes a fruit smoothie, daily fresh pastries, cookies, fruit basket and savoury snack in the afternoon.
- Luxurious wraps and sandwiches, salad bar, three warm lunch dishes and dessert including coffee, tea and Amsterdam Water

### Signature

- Dedicated meeting room
- The use of 1 beamer and screen in the meeting room
- Complimentary high speed wireless internet
- Welcome coffee and tea with cookies
- Morning and afternoon break which includes a fruit smoothie, daily fresh pastries, cookies and a savoury snack in the afternoon
- Freshly prepared daily changing lunch buffet including coffee, tea and Amsterdam Water
- Package is available from a minimum of 25 pax

### Green Globe

- Dedicated meeting room
- The use of 1 beamer and screen in the meeting room
- Complimentary high speed wireless internet
- Welcome fairtrade coffee and organic tea
- Extensive Mövenpick coffee breaks in the morning and afternoon – consisting of biological and local products such as bio fruit market, super food station, carrot cake, smoothies, honeycomb, vegetable crudités and muesli bars
- A market fair trade lunch buffet, including fairtrade coffee, organic tea, Amsterdam Water and biological juices
- Package is available from a minimum of 25 pax
- Paperless meeting (optional)
- Attendees use clean means of transport such as the tram, cycling or walking

### Flash meeting

- Meeting room
- Amsterdam Water
- Morning break with coffee/tea and cookies
- Sandwich lunch with a warm snack, including coffee/tea and Amsterdam Water during lunch
- Afternoon break with coffee/tea and cookies
- LCD projector
- Screen
- Package is valid from 0 – 14 delegates and for a fixed package price

---

The dedicated meeting room included in the package is based on our standard conference set-up and availability.

## Different day – different break

Try one of our famous superfood stations – an exclusive pleasure at any event.



### Classic Break Morning

- Mövenpick Fairtrade Coffee
- Tea selection
- Fresh seasonal fruits
- Cookie jar
- Amsterdam Water

### Classic Break Afternoon

- Mövenpick Fairtrade Coffee
- Tea selection
- Fresh seasonal fruits
- Dutch treats
- Amsterdam Water

### Signature Break Morning

- Mövenpick Fairtrade Coffee
- Tea selection
- Fruit smoothies
- Fresh seasonal fruits
- Daily fresh pastries
- Cookie jar

### Signature Break Afternoon

- Mövenpick Fairtrade Coffee
- Tea selection
- Fruit smoothies
- Fresh seasonal fruits
- Daily fresh pastries
- Savoury snack
- Amsterdam Water

### Green Globe Break Morning

- Mövenpick Fairtrade Coffee
- Organic tea
- Mix and Match juice stand
- Biological fruit market
- Super food station
- Honeycomb
- Smoothies
- Carrot cake
- Amsterdam Water

### Green Globe Break Afternoon

- Mövenpick Fairtrade Coffee
- Organic tea
- Mix and Match juice stand
- Biological fruit market
- Super food station
- Honeycomb
- Muesli Bars
- Vegetable crudités
- Amsterdam Water

---

Additional soft drinks or fresh juices can be added to the meeting package at a supplement.



## Lunch

### Chef's daily changing lunch buffet

- We provide you with a daily changing lunch buffet; a wide variety of fresh and typical, local dishes (hot and cold), inspired by the season and all prepared at the live cooking station when served in the restaurant

### 2-course set lunch

- An extra course can be added at a supplement

### Sandwich lunch

- An assortment of sandwiches, rolls and wraps

### Supplements

- Soft drinks
- Fresh juices
- Wine



## Dinner

### Chef's daily changing dinner buffet

- We provide you with a daily changing dinner buffet; a wide variety of fresh and typical, local dishes inspired by the season, all prepared at the live cooking station when served in the restaurant.

### 3-course dinner

- A tasteful combination of dishes

### 3-course dinner beverage package

- 3 glasses of Mövenpick house wine, beer or soft drinks

### Gala dinner

- Welcome cocktail or prosecco
- Hors d'oeuvres
- 3- or 4-course dinner
- Red and white house wine
- Amsterdam Water on the tables
- Coffee, tea and soft drinks
- Menu cards
- Flower decoration on the tables
- Use of private dining room





## Snacks & Bites

### Dutch snacks

- Ossenworst, leverworst, “Old Amsterdam” cheese, vlammetjes, cheese sticks, shrimp croquettes and bitterballen

### International canapés

- Please contact your C&E Executive for the latest menu

### Open bar

- Beer, house wine and soft drinks
- International spirits at a supplement
- All open bar packages are served with mixed nuts



## Catering

### Crew catering

- Unlimited coffee and tea
- Unlimited soft drinks
- Morning and afternoon breaks with pastries, a savory snack and fresh seasonal fruits or grab and go snack station
- Sandwich lunch with a hot snack
- Dinner
- Late night hot snack





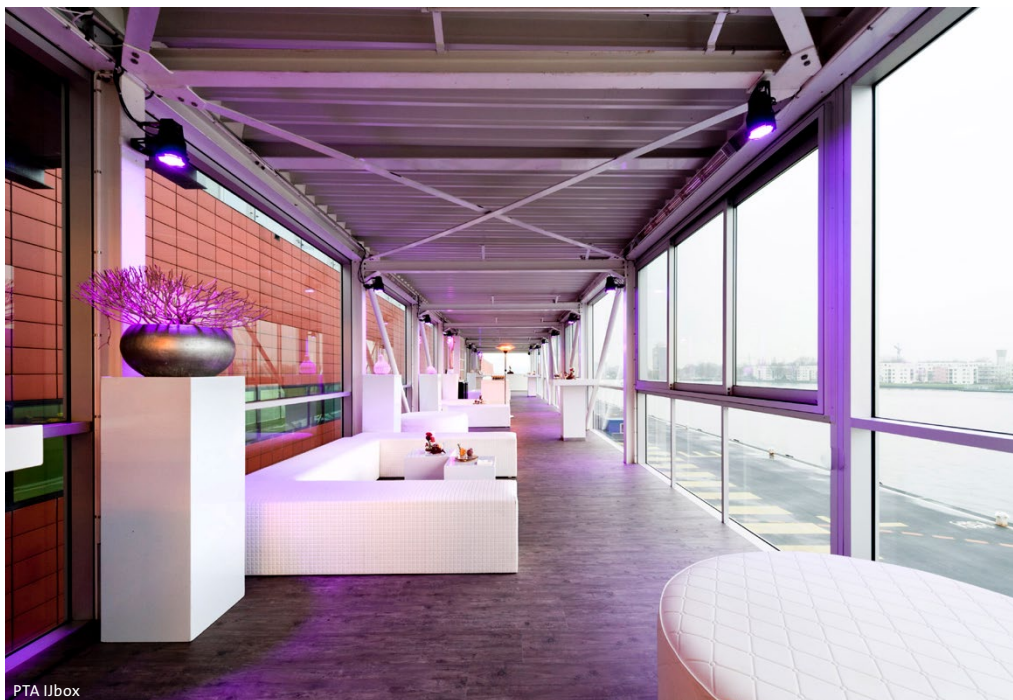

## Add something special

When you're looking for something special to add to your conference, we can create a memorable program for you.

Because of our waterfront location, big ships can dock directly next to the hotel. Why not have your dinner or event including music on board of our partner OCEAN DIVA?

**We have everything to provide the right ambience for you**

- Gala dinners
- Product launches
- Dinners on board
- Leisure activities

**Contact our sales team for a bespoke offer**

hotel.amsterdam.rfp@movenpick.com  
+31 20 519 12 24

*Request  
now*



## MEETING PLANNER

*Your events. Your rewards.*

Get rewarded whenever you plan a professional event with the ALL Meeting Planner.

Earn points at every event, redeem your points to pay for future events, and enjoy all the benefits of the ALL bonus program.

[JOIN NOW](#)

**ALL**  
ACCOR · LIVE LIMITLESS



## Reservation

Spectacular city views and views of the IJ River are just some of the highlights at Mövenpick Hotel Amsterdam City Centre, just 20 minutes from Schiphol Airport.

For more Information or reservation, please contact us.

+31 20 519 12 24

[hotel.amsterdam.rfp@movenpick.com](mailto:hotel.amsterdam.rfp@movenpick.com)

## ijVENUES

We are part of ijVENUES. ijVENUES can easily host large events and conferences. Within 10 minutes from the central train station we present modern spaces like an impressive auditorium and giant exhibition space.

[www.ijvenues.com](http://www.ijvenues.com) | [info@ijvenues.com](mailto:info@ijvenues.com)

## Green Globe

The Mövenpick Hotel Amsterdam City Centre received the Green Globe Gold certificate in 2015 and the Green Globe Platinum certificate in 2021. This recognition is awarded to Green Globe members that are certified for 10 consecutive years. Along with our Platinum rating, we have developed a Green Globe meeting package to help reduce the effect of your meetings on the environment. We are aware of the impact at our daily business makes on the world and locally. If you have any ideas or suggestions on how we can improve our sustainability we appreciate it when you share them with us.



Mövenpick Hotel Amsterdam City Centre  
Piet Heinkade 11 | 1019 BR Amsterdam | Netherlands  
+31 20 519 1200 | [hotel.amsterdam@movenpick.com](mailto:hotel.amsterdam@movenpick.com)

[f movenpickhotelamsterdamcitycentre](#)  
[@ movenpick\\_amsterdam](#)

[movenpick.com](http://movenpick.com)